



INSTALLING THE HIDE CONCRETE SKIMMER LID

1 ESTABLISH THE FINISHED HEIGHT

Calculate the boxing/form work required so the top rim of the installed Edge Protector (C) will achieve a flush finish with the surrounding surface.

2 ALLOW FOR SLAB MOVEMENT

The Edge Protector (C) will remain in position during the slab pour, being part of the form work around the skimmer lid. A clearance/expansion joint may be necessary to allow for slab movement.

3 EARTHING (BONDING) RULES AND REGULATIONS



HIDE products are constructed from 316 marine grade stainless steel, and are considered a conductive material. Safety regulations vary and you should consult your local authority to determine what rules may apply in your area.

4 Bonding is the responsibility of the installer, attachment points have been provided to allow for use of bonding devices if required. Check your local regulations to ensure the installation meets electrical safety requirements.

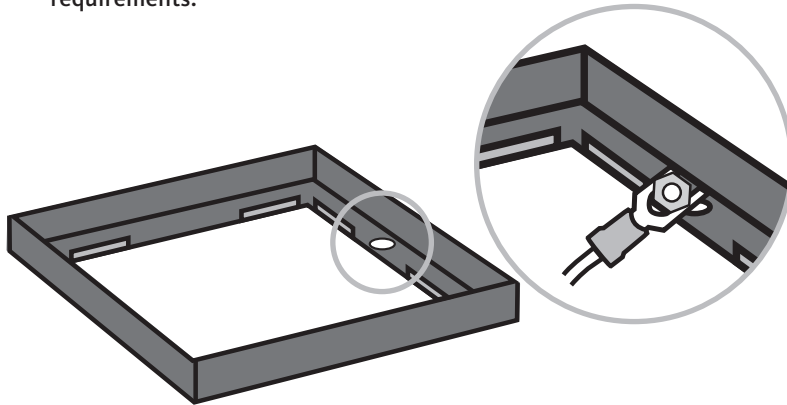

6 PREP THE INLAY LID

Set the Inlay Lid (B) face-up on a flat work surface away from the main slab pour area. To achieve a seamless finish, the Inlay Lid should be filled with the same concrete mix poured directly around the skimmer box. When filling the Inlay Lid (B), be sure to allow for any finishing procedure that may change the surface height of the set concrete. Applying a petroleum-based or non-stick coating to the outside of the Inlay Lid will assist during the final clean-up.

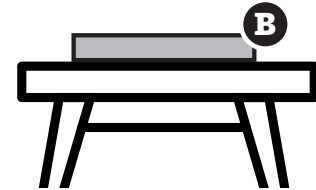

7 CLEAN SURFACES



As soon as possible, clean any concrete residue from the exposed parts of the Edge Protector (C) and Inlay Lid (B).



WARNING!

DO NOT ALLOW ACID OR CHEMICAL WASH SOLUTIONS TO CONTACT THE HIDE PRODUCT.

If washing with acid/chemicals, take protective measures to ensure minimal contact with the stainless steel HIDE components. Before use of acid/chemical wash, apply a water-resistant lubricant to the HIDE parts. When finished, immediately clean the HIDE components thoroughly to remove residual acid/chemicals.

COMPLETED INSTALL (CROSS SECTION VIEW)

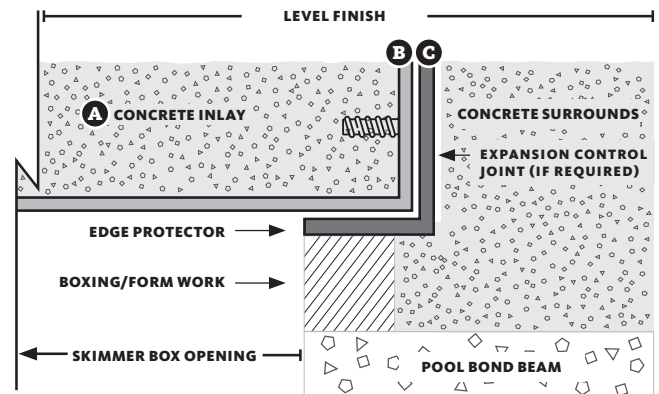

Operation requires a two handed vertical lift by **AN ADULT ONLY**. Support your back and do not lift a weight beyond your limits. Ensure Safety Keys remain in the locked position at all times. Keep feet away from the lid and recess frame at all times.

OPENING THE DOUBLE KEYWAY HIDE LID

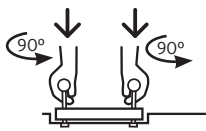

Insert both Safety Keys and turn to 90° so they lock into the back of the lid.

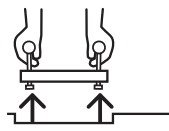

Lift vertically, just enough to clear the recess.

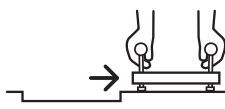

Set safely aside. Do not carry the lid at a height.

CLOSING THE DOUBLE KEYWAY HIDE LID

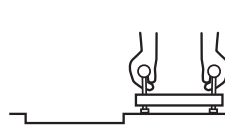

Using both hands, grip each Safety Key, keeping them at a 90° position.

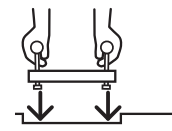

Position the lid above the recess and lower down vertically.



Remove both Safety Keys and store away from children.

NOTE - INSTALLATION IS ONLY COMPLETE WHEN:

NEVER leave the QUAD Safety Key in the lid for any reason, especially after install. Leaving the Safety Key in an installed lid exposes a contractor to possible legal ramifications if a resulting accident or injury occurs.

PASS the Safety Key to the homeowner for secure storage. The "Home Owners Manual" packet should also be given to the homeowner.